

ALLDAY
& MILLER



Wood End Green Road, Hayes, UB3 2SG
£289,000

2 1 1 C



Wood End Green Road, Hayes, UB3 2SG

£289,000

- Two Bedrooms
- Maisonette
- Chain Free
- Good Schools Nearby
- First Floor
- Courtyard Garden
- Close To The Uxbridge Road
- Easy Reach To An Elizabeth Line Station

Description

Nestled on the desirable Wood End Green Road this charming property offers a wonderful opportunity for both first-time buyers and those looking to downsize. Spanning an approx. 631 square feet and boasting a well-thought layout that maximizes space and comfort.

Upon entering, you are greeted by a spacious reception room, perfect for relaxing, the room is filled with natural light, creating a warm and welcoming atmosphere, a sleek fitted kitchen, two generous bedrooms, each offering a peaceful retreat for rest and relaxation. Completing this delightful home is a modern bathroom.

Situation

Wood End Green Road giving easy access to the Uxbridge road with its variety of local shops, takeaways, coffee shops and cafes. A number of bus/road links including the M40, M4 and M25 with its links to London and the Home Counties. Hayes Town Centre is just a short drive away with the Elizabeth Line, making the journey into Central London a breeze. The area is served by highly regarded schools in the local area including Rosedale College, Colham Manor primary school and Botwell House Catholic school.



Floor Plans

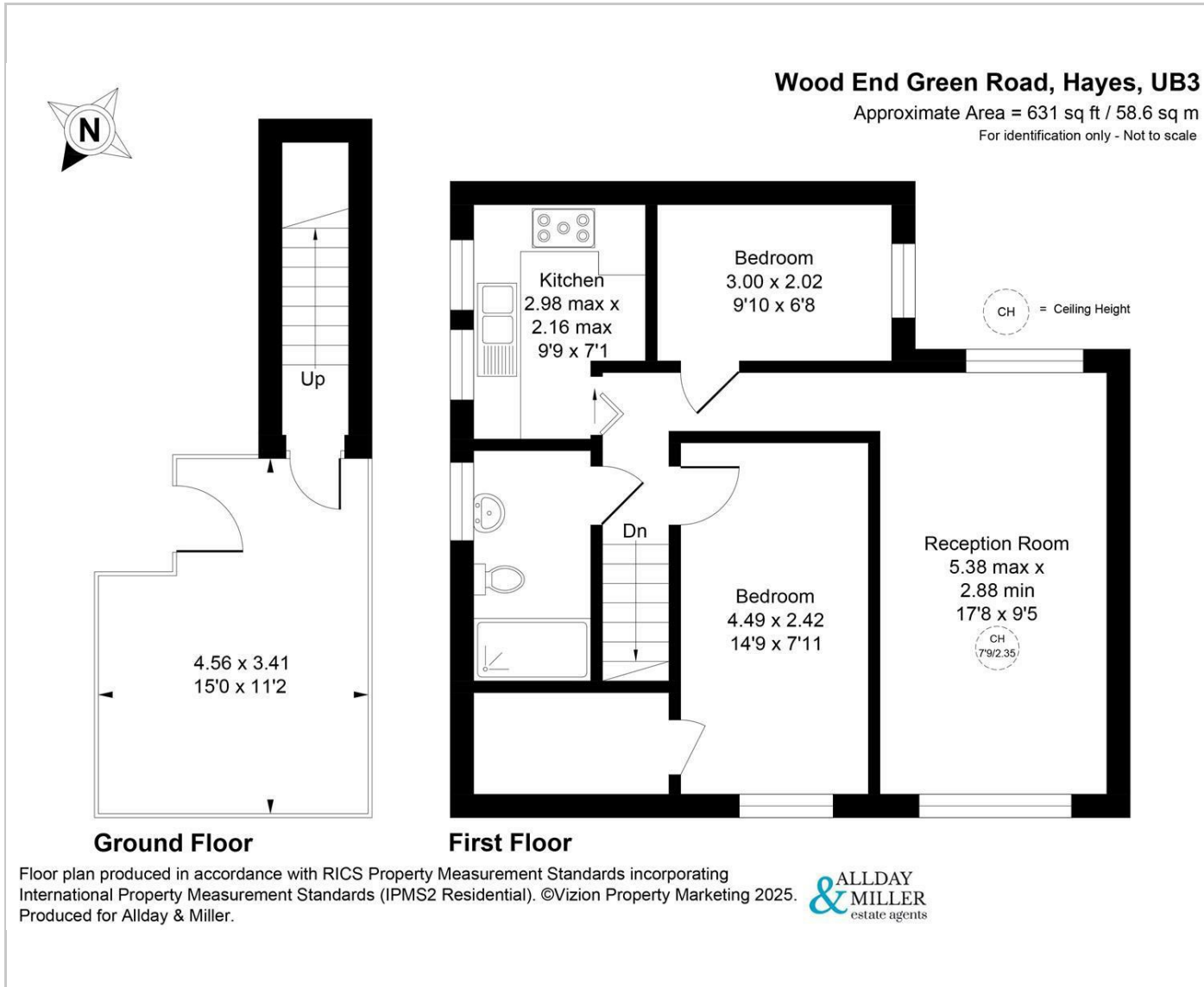

Area Map

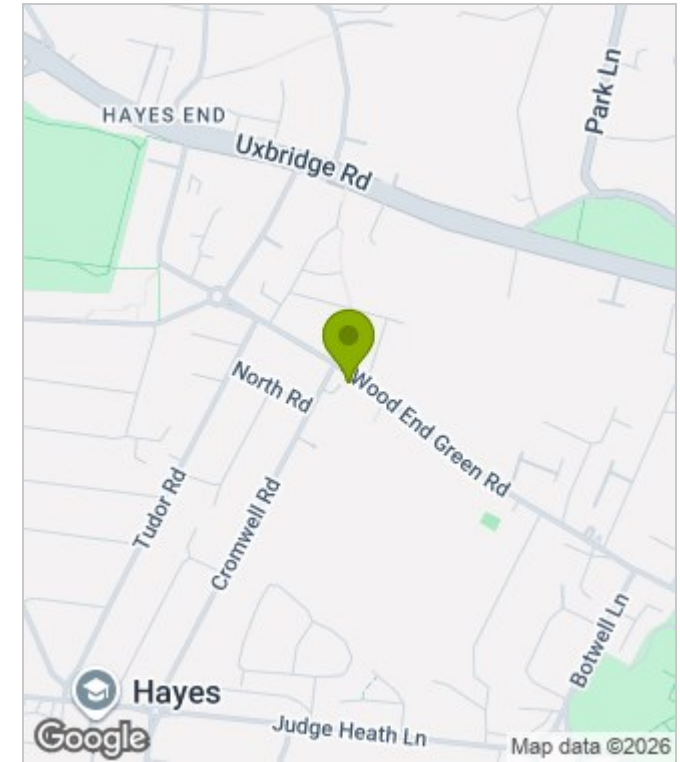

Energy Performance Graph

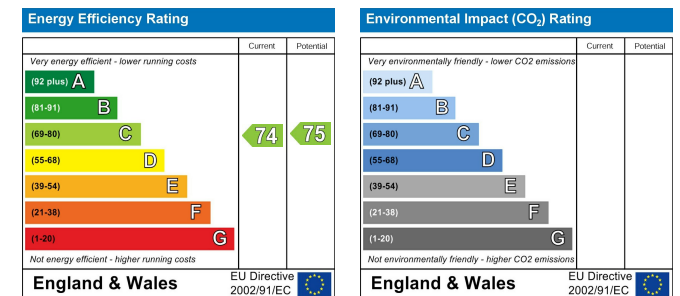

These particulars, whilst believed to be accurate are set out as a general outline only for guidance and do not constitute any part of an offer or contract. Intending purchasers should not rely on them as statements of representation of fact, but must satisfy themselves by inspection or otherwise as to their accuracy. No person in this firm's employment has the authority to make or give any representation or warranty in respect of the property.